



Pong Bot Tennis Ball Machine Setup & App Operation Equipment Needed

PongBot Tennis Ball Machine (Located under the Stairs on Court 1)

Battery Pack (On Charger by Net Post on Court 1)

PongBot Mobile App (iOS or Android)

Smartphone or tablet with Bluetooth and Wifi enabled

Step 1: Download Pongbot App

Download Pongbot app and create an account

We recommend downloading/creating an account prior to arrival to maximize your Court Time

Step 2: Position the Machine

Place the PongBot machine behind the baseline, centered unless a specific drill requires a different location.

Step 3: Load Tennis Balls

Separate the ball hopper from the robot. After rotating it to an upright position, install it above the robot. Note that the arc end of the ball hopper should face forward.

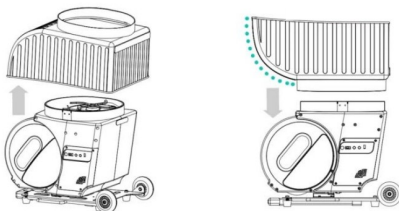

Step 4: Power On/Connecting to PongBot App

1. Slide the switch of the robot to the “|” position to turn on the robot.
2. Turn on the Bluetooth and location functions of the mobile phone/tablet on which the PongBot Tennis APP is installed. Internet access is required during the use of the APP.
3. Open the PongBot Tennis APP, click “+”, select the corresponding robot model, and the APP will automatically search for nearby robots.
4. Select the searched robot, click “Connect”, and then click “Confirm” again after the connection is successful.

Step 5. Running a Drill

Classic Drills The combinations in Classic Drills are preset in the PongBot Tennis APP. Select one to start exercising quickly.

①	Combination Selection	You can choose basic, combined and complex exercises (classified by the number of single balls in the combination).
②	Combination List	Show all preset combinations, which are named comprehensively based on relevant technical labels, left/right hand information, landing positions, etc. Scroll the screen up and down to view more preset combinations. (The pictures in the instruction manual are for reference only. Refer to the actual combination list in the APP.)
③	Position information	Indicate the placement position information of the currently selected robot.

When Ready Click Start. Click Stop Feed in the App to end the drill.

Step 6. Safety Guidelines

Ensure players are ready before starting the feed.

Never stand directly in front of the machine while active.

Stop the machine before adjusting the hopper or machine position.

Keep hands clear of the feeding wheels.

Step 7. Ending the Session

Press Stop Feed in the app.

Turn the machine power OFF.

Remove remaining balls and place back in hopper

Flip Ball machine hopper into the "store" Configuration

Store the machine properly under the stairs on Court 1

Put Battery Back on Charger on Court 1